

AQUA-PRO AQUARIUMS

Installation Instructions

For Freshwater and Aquascaper aquarium ranges

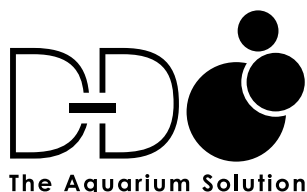

FOLLOW US FOR INSPIRATION!

 fb.com/theaquariumsolution  fb.com/groups/ddaquapro

— www.theaquariumsolution.com —



D-D Aqua-Pro Freshwater and Aquascaper Aquariums

Please read the following installation instructions carefully before starting to assemble and run your aquarium. If correctly installed, your new aquarium should give you years of pleasure in this fantastic and enthralling hobby.

POSITIONING THE AQUARIUM

Your Aqua-Pro aquarium when filled with water and substrate will be very heavy!

You must establish a suitable position and ensure that the floor or cabinet which you are installing it on is suitable for the weight of the tank, water and substrates without deforming or collapsing. Specific Aqua-Pro cabinets are available and designed to support your aquarium properly. If you are uncertain that your floor will be strong enough, or requires support, please take professional advice.

If the aquarium is not being positioned on a specific Aqua-Pro cabinet care must be taken to ensure the surface is flat and level. Failure to do so may cause the aquarium to crack or the silicone joints to fail over time.

We recommend that any aquarium should be positioned out of direct sunlight and away from a static heat source, such as a radiator.

When positioning it is important to have enough people to safely move the aquarium. Jewellery that

could potentially scratch the glass or cabinet finish should be removed prior to moving any aquarium or cabinet.

CHECKING THE AQUARIUM ON ARRIVAL

Transport damage – your aquarium will arrive fully protected and should be carefully unwrapped and checked for any damage.

You must check the aquarium and report any transport damage to your retailer within 12 hours of delivery.

Ensure that there are no missing or damaged parts. Report any issues to your retailer within 24 hours.

IF THERE ARE ANY ISSUES OR CONCERNS THEN DO NOT FILL THE AQUARIUM WITH WATER

Although the tanks are cleaned prior to packing we recommend using a soft sponge and clean water to wipe the inside of the aquarium before setup to remove any residue dust or debris.

Approximate system weights

AQUA-PRO FRESHWATER AQUARIUM	TANK WEIGHT	WATER VOLUME	CABINET WEIGHT	TOTAL WEIGHT	ADJUSTABLE FEET (METAL FRAME VERSION)	PEOPLE REQUIRED
600	42 Kg	170 L	35 Kg	247 Kg	n/a	2
600 CUBE	45 Kg	205 L	43 Kg	293 Kg	n/a	2
900	67 Kg	256 L	42 Kg	365 Kg	n/a	2
1200	80 Kg	343 L	48 Kg	471 Kg	n/a	2-4
AQUA-PRO AQUASCAPER AQUARIUM						
600	22 Kg	98 L	35 Kg	155 Kg	n/a	1
900	43 Kg	185 L	42 Kg	270 Kg	n/a	2
1200	70 Kg	293 L	54 Kg	417 Kg	6	2-4
1500	120 Kg	444 L	62 Kg	626 Kg	6	4
1800	177 Kg	521 L	70 Kg	768 Kg	8	6

IMPORTANT: Aquarium care

The Aqua-Pro aquarium cabinet is designed as a piece of furniture and although it is water resistant it is NOT WATERPROOF and requires care and attention to prevent damage.

It is important that any water spillage or standing water is wiped up immediately to prevent damage to the board or edging which would not be covered under warranty.

Chemical products should not be used to clean the aquarium or cabinet as they may be toxic to aquatic life.

To avoid scratches when cleaning the glass do not use abrasive materials and take care when using bladed cleaners.

AQUA-PRO FRESHWATER AQUARIUM

The Aqua-Pro Freshwater aquariums come complete with two LED lights, light mounting bar and two lid flaps. These can be removed completely for maintenance or the lid flaps hinged back for feeding or quick access. and two lid flaps. These can be removed completely for maintenance or the lid flaps hinged back for feeding or quick access.

Tank Cut Outs

Every Aqua-Pro Freshwater aquarium includes cut outs in the back of the glass tank. These enable power cables, pipework for external filters, airline etc to be passed through whilst keeping a neat finish on top of the tank.

When cleaning the aquarium ensure that water does not splash through the cut outs in the rear of the tank. Any spillages on the tank or stand should be dried up immediately.

It is very important that these cut outs are not used to lift or move the aquarium at any time as damage may occur.

Fitting the LED Tubes

The light mounting bar comes with plastic clips capable of holding up to four LED light tubes. The LED tubes are made from glass so care should be taken when handling them to avoid breakages. Each tube can clip into any of the four available positions. For even light spread throughout the aquarium we recommend that the two tubes supplied with the aquarium are positioned in the outer most positions front and back.

The power cables from the LED tubes can be passed through the cut outs in the rear of the aquarium. A 'drip loop' must be created in each power cable to prevent water travelling along the cord and coming into contact with the electrical socket. Never remove the plug from the power socket by pulling on the power cable.

To avoid a possible electric shock, ensure all electrical devices are switched off before carrying out maintenance.

Levelling the Cabinet

Ensure that the area where the tank is to be installed is clear so that you have plenty of space for access and adjustment. The cabinet should be initially levelled without the tank and we recommend that you remove the quick release doors for better access by pressing the lever at the back of each hinge.

Preparation

Two different cabinet versions are available for some sizes in the Aqua-Pro aquarium range, wooden cabinets and metal framed cabinets.

Wooden Cabinet

The wooden cabinet should ideally be positioned on a level, flat floor. If the floor is not completely level or flat, then it will be necessary to use suitable shims to level the cabinet, (follow same process as for metal framed cabinet). This is important to avoid warping or movement over time and to ensure that the aquarium is fully supported.

Metal Framed Cabinet

The metal frame cabinet comes with 6-8 adjustable feet, depending on model.

Start by establishing if your floor is level by placing the cabinet roughly in position and using a spirit level on the top of the frame or top. A spirit level of at least 60-90cm in length will be required.

1. Level back to front.

- Cabinet leans backwards – extend all back feet, on larger models adjust middle foot first.
- Cabinet leans forwards – extend all front feet.

2. Level side to side.

- Cabinets with centre feet – if one end is higher than the middle, raise both centre feet to match the highest point. Adjust all other corner feet down to firmly touch the floor.
- Cabinets without centre feet – extend feet at lowest end until level.

3. Final cabinet check, adjust if necessary.

- Re-check top of frame is level front to back and side to side, at multiple points.
- Re-check all feet are firmly on the floor.

POSITIONING THE TANK

Place the tank carefully onto the top of the cabinet, ensuring that the protective base mat is sandwiched between cabinet top and tank base. The rear corners of the aquarium should line up with the rear corners of the cabinet. The front of the aquarium will protrude over the cabinet top but align with the cabinet perimeter when the doors are installed and closed.

After installing the tank, but before filling, check the level again by placing the spirit level along the top edges of the tank and make any fine adjustments. Leave the tank to settle for a couple of hours and then re-check and adjust if necessary.

CABINET CUT OUTS (AQUASCAPER AQUARIUM ONLY)

The Aqua-Pro Aquascaper cabinet comes with circular cut-outs in the sides. These are for external filter pipework, CO2 hose and lighting cables to enter and exit the cabinet neatly leaving the rear view of the aquascape unobstructed. The cut-out itself comes with a removable insert, which is adjustable in orientation or can be removed entirely leaving the silver effect trim and maximum width for larger external filter hoses.

ADJUSTING THE CABINET DOORS

The doors are pre-set in the factory before packing but the hinges may need to be adjusted slightly once the aquarium is in its final location. It is best to adjust the cabinet doors at the end of installation when the tank is full of water.

The soft-close hinges have three points of adjustment. If necessary, make adjustments until the door(s) are level,

with an even gap, and close without any obstruction. The push-openers can also be adjusted by twisting them in or out, by hand.

The hinges can show signs of rust over time if splashed with water or with high humidity. For extra protection silicone grease can be applied to their surface to provide a protective barrier. Rust on the surface of the hinge is not covered by warranty.

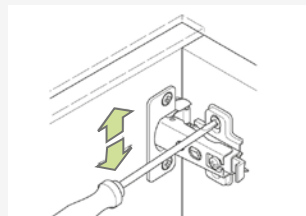

Height

The cabinet doors can be height adjusted marginally with the screws as shown. Loosen the screws on the top and bottom of both hinges and the door will drop down. Lift door into position and tighten screws.

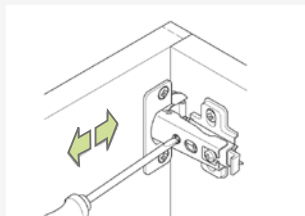

Left to right

Adjustment of the screw as shown will enable left and right alignment of the door. Adjustment of both hinges on the door this way can be used to square it up and will affect the gap between each door when closed.

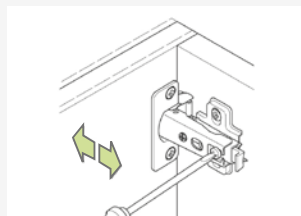

Front to back

The door can be brought forward by loosening the screw as shown. Pull the door out or push it in then tighten screw to fix the position.

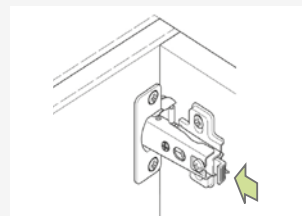

Quick release

The hinges have a quick release mechanism. Push the button at the back of the hinge to release the door, without having to undo the screws.

To compliment and benefit your new aquarium we recommend the following equipment and products...



Prime 16HD

Prime Flex 18



Slimline Bracket
Gen 2

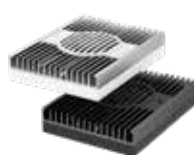

Hydra 32HD

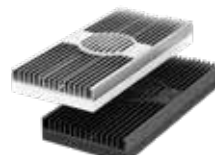

Hydra 64HD



Nero Wave Pumps



RowaPhos
Phosphate Remover



Dual Heating and Cooling
Controller



AI Blade Lighting



D-D Titanium Heater



DC Series Chillers



ClariSea Fleece Filter



D-D Compact
ATO



Deltec Skimmers



FMR75
Fluidised Reactor



H2Ocean Reef Salt



Jumpguard Aquarium Cover

RECOMMENDED LIGHTING OPTIONS FOR AQUA-PRO AQUASCAPER

Aquascaper 600	1 x Freshwater Prime 16HD + 1 x Prime flex mount 12" alternatively 1 x BLADE 21" Freshwater
Aquascaper 900	2 x Freshwater Prime 16HD + 2 x Prime flex mount 12" alternatively 1 x BLADE 30" Freshwater
Aquascaper 1200	2 x Freshwater Prime 16HD + 2 x Prime flex mount 18" alternatively 1 x BLADE 39" Freshwater
Aquascaper 1500	3 x Freshwater Prime 16HD + 3 x Prime flex mount 18" alternatively 2 x BLADE 57" Freshwater
Aquascaper 1800	4 x Freshwater Prime 16HD + 4 x Prime flex mount 18" alternatively 2x BLADE 66" Freshwater